

**BRASS FITTINGS**

**BRASS FERRULES**



**Brass Ferrules**

For use in Shop air and whip hoses.

**SPECIFICATIONS**

PRODUCT I.D.		"A" FERRULE I.D. (IN.)	"B" HOLE SIZE (IN.)	"C" FERRULE LENGTH (IN.)	STD. PKG.
RB&H #	REFERENCE #				
BF-4530	769	.453	.34	0.56	100
BF-4750	4750	.475	.33	0.69	100
BF-5000	624	.500	.36	0.47	100
BF-5005	7322	.500	.34	1.00	100
BF-5255	7323	.525	.38	1.00	100
BF-5310	7324	.531	.38	1.00	100
BF-5500	626	.550	.38	0.47	100
BF-5620	7325	.562	.44	1.00	100
BF-6000	JJ	.600	.44	0.47	100
BF-6250	II	.625	.44	0.47	100

**SPECIFICATIONS**

PRODUCT I.D.		"A" FERRULE I.D. (IN.)	"B" HOLE SIZE (IN.)	"C" FERRULE LENGTH (IN.)	STD. PKG.
RB&H #	REFERENCE #				
BF-6255	7327	0.625	.44	0.50	100
BF-6560	7328	0.656	.44	1.00	100
BF-6750	GG	0.675	.44	0.50	100
BF-6900	7329	0.690	.50	1.00	100
BF-7180	7330	0.718	.63	1.00	100
BF-7250	EE	0.725	.50	0.53	100
BF-7505	7331	0.750	.63	1.00	100
BF-7810	7332	0.781	.63	1.00	50
BF-8750	7244	0.875	.63	0.88	50
BF-9950	7104	1.150	.88	0.88	50

**THREADED SLEEVE**

**PRESSURE:** Up to 500 psi for 1/8" to 1/4" sizes. 250 psi for 5/16" and 3/8" sizes (Does not include plastic tubing).

**USED WITH:** Copper, aluminum and plastic tubing. Not recommended for steel tubing. Soft plastic tubing requires internal tube support.

**TEMPERATURE:** -65°F to +250°F.

**APPLICATION:** Oil, air, water and lubrication systems.

**Quick Reference**

**QUICK REFERENCE CHART**

DASH SIZE	TUBE O.D. (IN.)	TUBE THREAD SIZE (IN.)	PIPE THREAD SIZE (IN.)
2	1/8	5/16 - 24	1/8 - 27
3	3/16	3/8 - 24	-
4	1/4	7/16 - 24	1/4 - 18
5	5/16	1/2 - 20	-
6	3/8	9/16 - 20	3/8 - 18

**Threaded Sleeve**

**SPECIFICATIONS**

RB&H #	TUBE O.D. (IN.)
6100X2	1/8
6100X3	3/16
6100X4	1/4
6100X5	5/16
6100X6	3/8

**Nut**

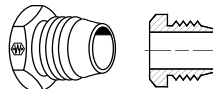

**SPECIFICATIONS**

RB&H #	TUBE O.D. (IN.)
6300X3	3/16
6300X4	1/4
6300X5	5/16

**Union**



**SPECIFICATIONS**

RB&H #	TUBE O.D. (IN.)	MALE PIPE (IN.)
6200X4	1/4	1/8
6200X5	5/16	1/8
6200X5X4	5/16	1/4
6200X6	3/8	1/4

**Male Connector**

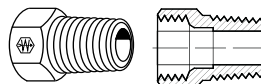

**SPECIFICATIONS**

RB&H #	TUBE O.D. (IN.)	MALE PIPE (IN.)
6400X2	1/8	1/8
6400X3	3/16	1/8
6400X4	1/4	1/8
6400X4X4	1/4	1/4
6400X5X4	5/16	1/4
6400X6	3/8	1/4

**Male Elbow**

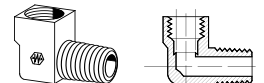

**SPECIFICATIONS**

RB&H #	TUBE O.D. (IN.)	MALE PIPE (IN.)
6550X3	3/16	1/8

**Adapter Tee**

